

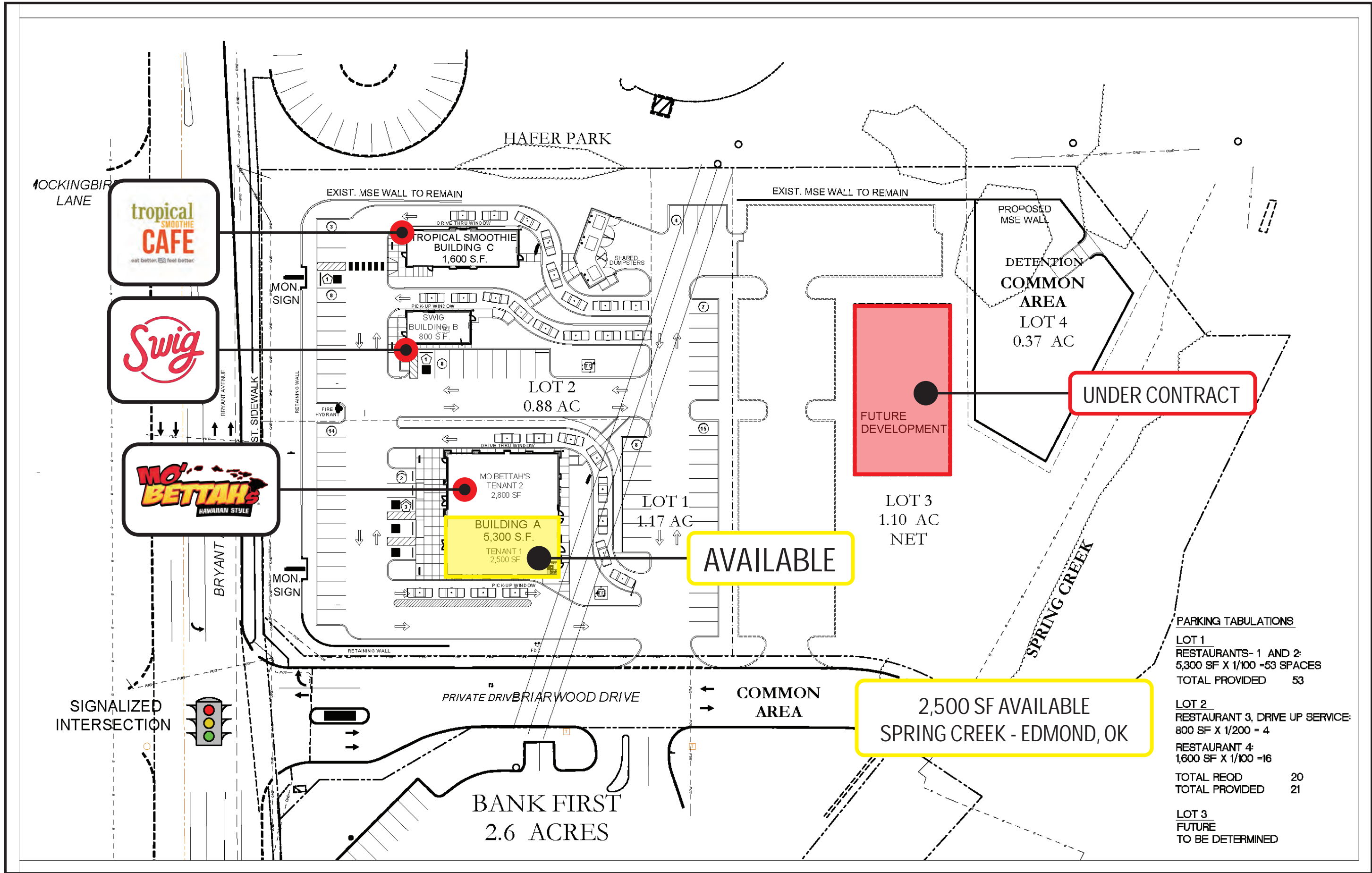

Spring Creek is located in the commercial corridor of Edmond, OK, on S. Bryant Avenue between E. 15th Street & E. 2nd Street. The site is directly adjacent to the Pelican Bay Aquatic Center and E.C. Hafer Park, a 121 acre park and athletic complex, with major retail developments at each of the at the intersections to the north and south.



PARKING TABULATIONS

Lot	Use	Area	Spaces
LOT 1	RESTAURANTS- 1 AND 2:	5,300 SF X 1/100	=53 SPACES
	TOTAL PROVIDED		53
	LOT 2	RESTAURANT 3, DRIVE UP SERVICE:	800 SF X 1/200 = 4
	RESTAURANT 4:	1,600 SF X 1/100 =16	
	TOTAL REQD		20
	TOTAL PROVIDED		21
LOT 3	FUTURE		TO BE DETERMINED



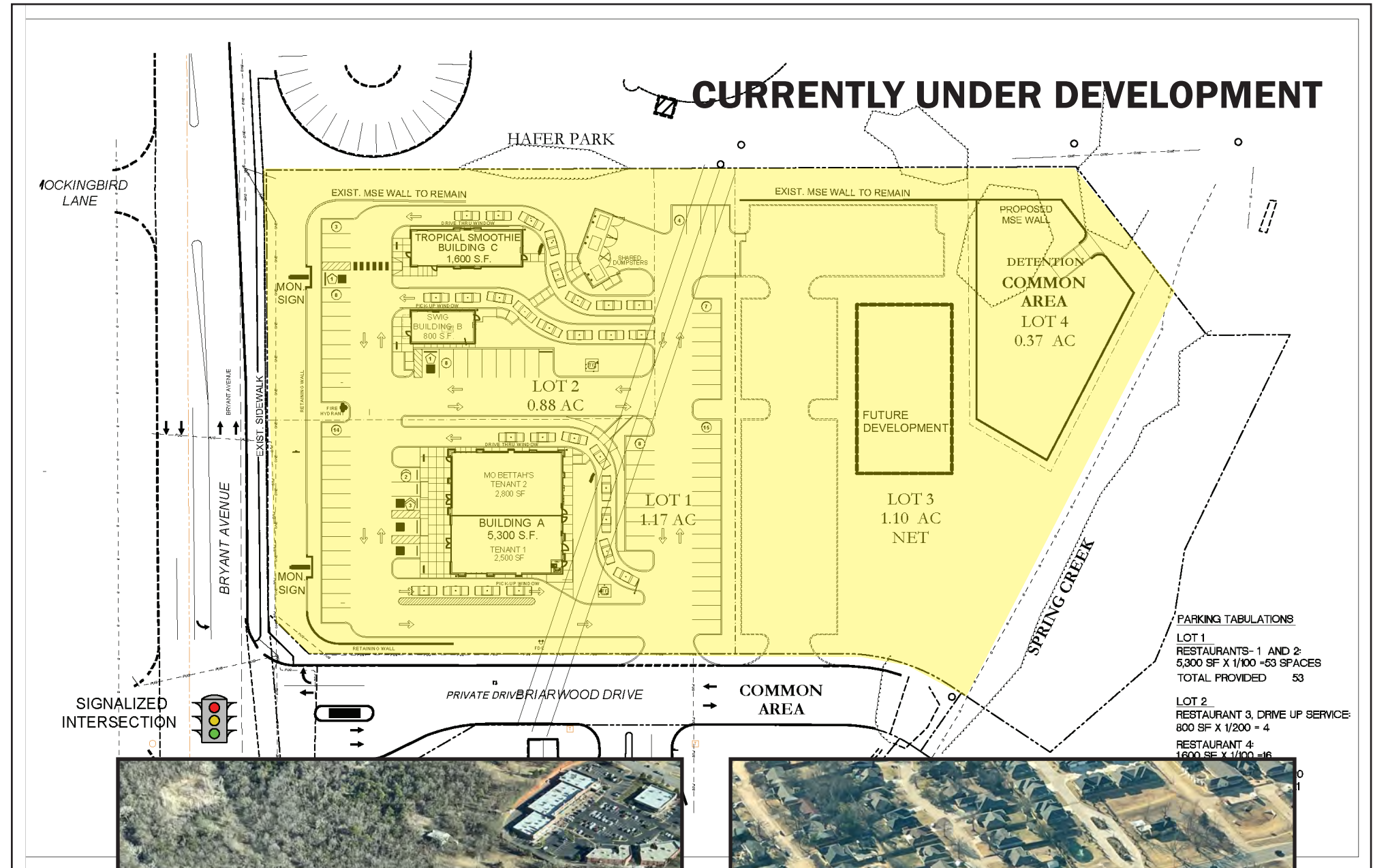

Edmond, OK

SPRING CREEK is located in the heart of the always growing and bustling, Edmond, OK. Nestled in the commercial corridor off S. Bryant Ave., between E. 15th St. and E. 2nd St., Spring Creek is surrounded by a rich variety of retail and dining options, as well as the aquatic center, parks, schools, and the University of Central Oklahoma. Edmond was ranked #1 on CNBC's list of "10 Perfect Suburbs", in 2011.

Relocate America listed Edmond as one of the "Top 100 Places to Live in 2007". Edmond has been selected the most outstanding community in its class for five years straight, by the State Chamber of Commerce and State Industrial Department, and is one of the ten most affluent cities in the state of Oklahoma.

Year 2017	5 Mile	7 Mile	10 Mile
Estimated Population	125,607	203,324	303,872
Estimated Average Household Income	\$102,222	\$96,158	\$96,273

